

➔ **BEYOND THE BEAUTY** of palmetto trees, sandy beaches, and award winning golf courses lays a vibrant business community in Horry County, South Carolina. Located halfway between New York and Miami, our superior schools, modern infrastructure and dynamic economy make Horry County home to many thriving businesses. Keeping Horry County one of the top 100 fastest growing counties in the nation and the second fastest growing MSA in the Carolinas requires dedication, professionalism, and an enterprising spirit coupled with the efforts of the regional business community.



**WE ARE COMMITTED TO GROWTH** Myrtle Beach is the 4th fastest growing area in the country by job-growth (Source: U.S. Bureau of Labor and Statistics, 2007). By 2015, the US Census projects that the Myrtle Beach area will continue to see population growth of over 20%. That's because we, as a community, are committed to retaining existing Horry County businesses and attracting new companies to our great area.

Companies interested in moving their businesses to Horry County are surprised by the abundance of skilled workers and the quality of the local school systems and higher education institutions. In fact, Horry County has invested \$500 million in the school district over the past twelve years.

South Carolina Department of Transportation has invested \$1.7 billion in Horry County roads over the past seven years, and our growth will continue as a result from the planned I-73/I-74 interstate that will link Myrtle Beach to Michigan.

AVAILABLE  
 WETLANDS

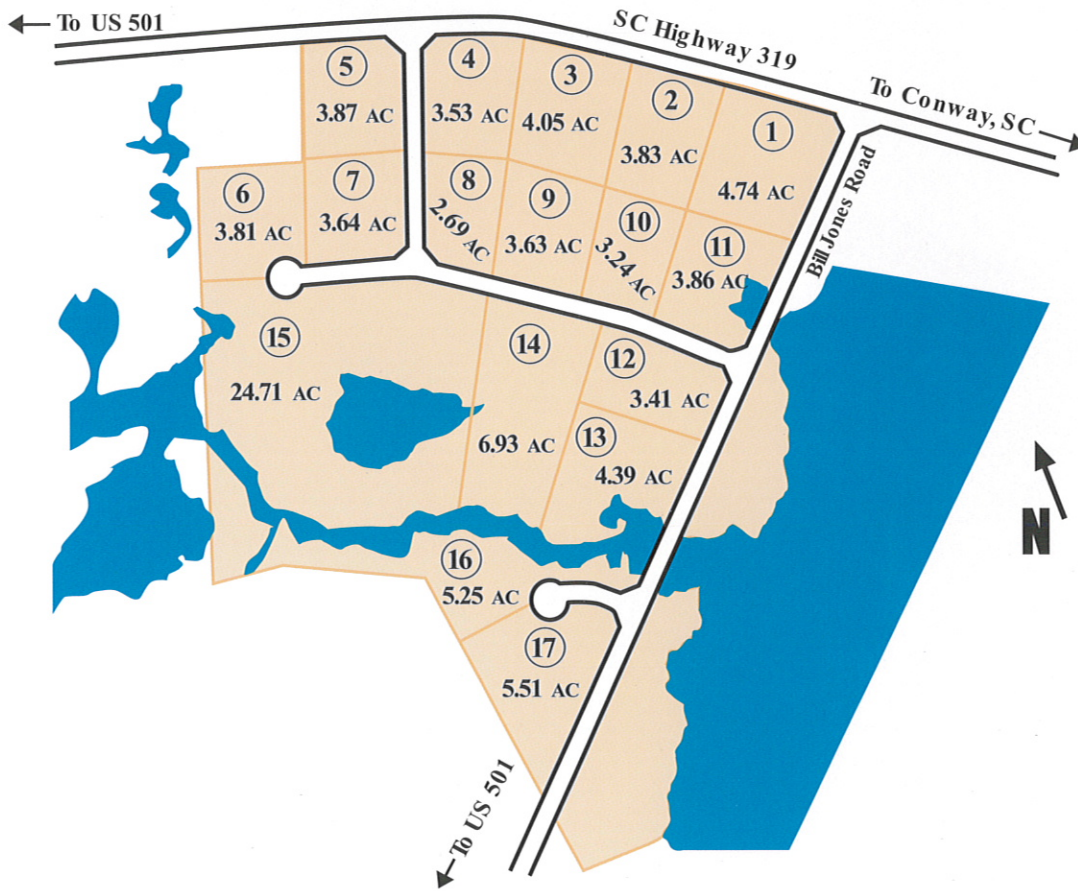

## ➤ COOL SPRINGS BUSINESS PARK

**ACREAGE**

Available: 200 acres - can be sub-divided (Phase I Certified)

**ZONING**

Class A Certified Industrial Park, Heavy Industrial

**WATER**

10 inch main, Grand Strand Water & Sewer

**SEWER**

8 inch main, Grand Strand Water & Sewer

**ELECTRIC**

Horry Electric Cooperative

**FIBER OPTICS**

Horry Telephone Cooperative adjacent to park

**GAS**

n/a

**U.S. HIGHWAY**

US Highway 501, 319

**INTERSTATE ACCESS**

I-95, Distance: 35 miles | I-20, Distance: 49 miles

**AIR SERVICE**

Myrtle Beach International Airport, Distance: 28 miles

**PORTS**

Charleston, 100 Miles | Georgetown, 73 miles | Wilmington, 51 miles

**GPS COORDINATES**

N33°59.8029, W 079°12.26874